

PCB-16S01

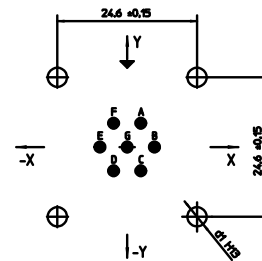

Bohrung Achse	Lage / position	
	X-Achse X-axis ±0,05	Y-Achse Y-axis ±0,05
A	2,40	4,20
B	4,80	0,00
C	2,40	-4,20
D	-2,40	-4,20
E	-4,80	0,00
F	-2,40	4,20
G	0,00	0,00

7 PC-Kontaktbohrungen Ø1±0,1

Ansicht ist auf der Steckseite Stift-Stecker gezeichnet.

Für Steckseite Buchen-Stecker ist das Bohrbild spiegelbildlich zur Hauptachse (↕)

Für Winkelverdrehung sind die Koordinaten entsprechend umzurechnen

7 PC-contact holes Ø1±0,1

View on mating face of pin-connector

For mating face of socket-connector the hole pattern is symmetrical to the main axis (↕)

For angular rotation the coordinates must be changed accordingly

Winkelverdrehung: W = 80°

angular rotations: Z = 280°



Ø1 HB	
Gehäuseform	shell type
CA 02L	CA 20L
34	45

Note: Due to an automatic nomenclature system, numbers generated may not be sequential.

Specification and Dimensions subject to change  
Drawings illustrate normal insulator positioning

Material Specification:

Shell Material:	Aluminium alloy
Shell Plating:	Olive drab chromate over cadmium (conductive)
Insulator Material:	CR-Elastomere
Contact Material:	Copper alloy
Contact Plating:	Hard silver

all dimensions are in mm  
Dimensions without tolerance indications are general tolerances in acc. with DIN7168m

drawing for  
CUSTOMER



description CA02L16S-1S-B  
Box mounting receptacle

Engineered for life  
ITT CANNON GmbH  
D - 71384 Weinstadt/Germany

PCB Ø 0,76 / Socket / Layout: 16S-1

© All rights reserved. Reproduction or issue to third in any form  
whenever is only permitted with written authorization of ITT Cannon



page 2/2  
revision 3589 6. May 24